

**EXISTING ELEVATOR DEMOLITION PLAN**

SCALE: 1/8" = 1'-0"

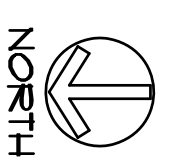

NORTH

SCALE NOTED ON DRAWINGS REPRESENTS 24" x 36" SIZE SHEETS OF PAPER

© 2010 ARCHITECTS IN ASSOCIATION, 1000 AND 3RD ST., N.W.

**LEGEND**

- LINE TYPE COMMONLY INDICATES EXISTING FEATURE
- ▨ INDICATES ITEM TO BE REMOVED

**GENERAL NOTES**

1. VERIFY ACTUAL DIMENSIONS & CONDITIONS IN FIELD AND NOTIFY ARCHITECT OF ANY PERTINENT DISCREPANCIES
2. CONFERT ALL REMOVAL WORK WITH REMOVAL PLANS (ARCHITECTURAL, MECHANICAL & ELECTRICAL)

**CAMPUS KEY PLAN**

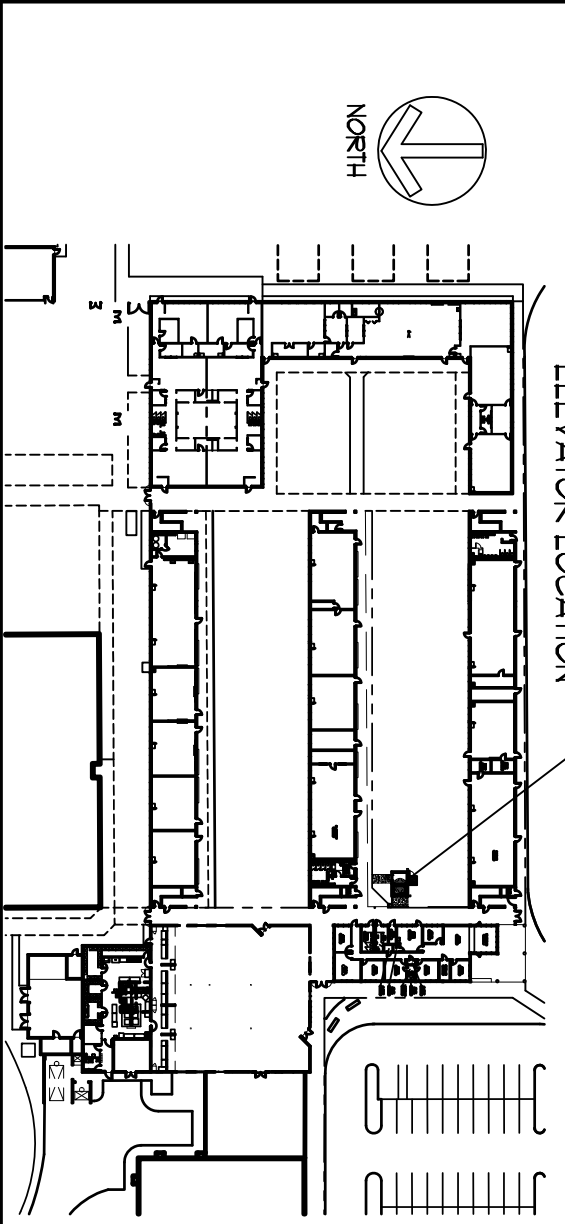

**REVISIONS & UPDATES**

NO.	DATE	DESCRIPTION
1	05/28/10	ISSUED FOR PERMIT & CONSTRUCTION
	09/21/10	ISSUED FOR PRICING

**NEW ELEVATOR**  
**EDGEWOOD JUNIOR/SENIOR HIGH SCHOOL**  
 MERRIITT ISLAND  
 FLORIDA  
**EXISTING ELEVATOR DEMOLITION PLAN**

drawn JDA approved JZ

JOHN C. ZWICK, R.A.  
 FL. REG. AR200095271

ADP | O

ARCHITECTS IN ASSOCIATION ROOD & ZWICK, INC.  
 800 FLORIDA AVENUE SUITE 202 COCOA, FLORIDA 32922 TELEPHONE (321) 631-8039