

PLAN NOTES

1. ALL DETAILS AND SECTIONS SHOWN ON THE DRAWINGS ARE INTENDED TO BE TYPICAL AND SHALL BE CONSIDERED TO APPLY TO ANY SIMILAR SITUATION ELSEWHERE ON THE PROJECT EXCEPT WHERE A DIFFERENT DETAIL IS SHOWN.

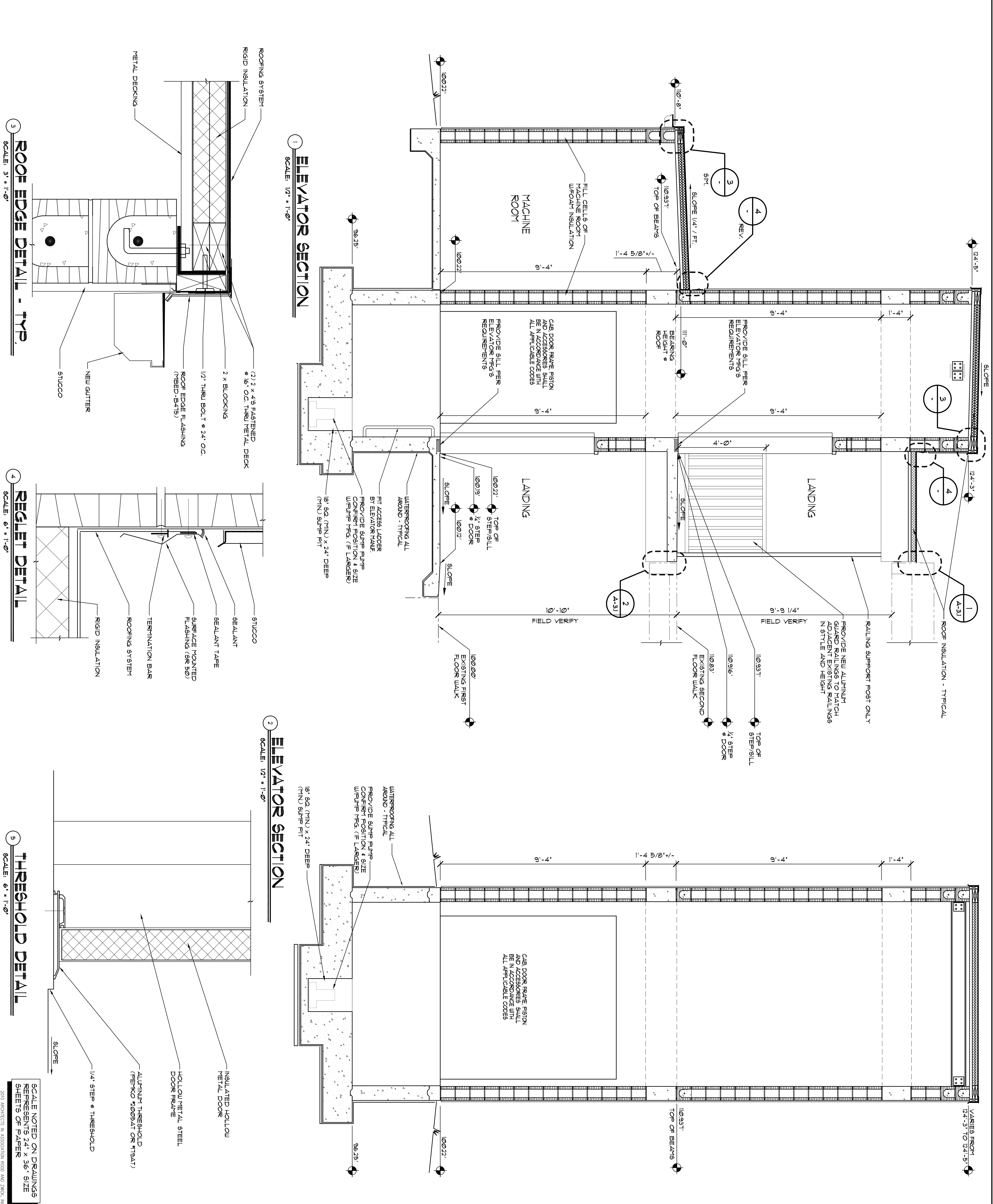

REVISIONS & UPDATES	
05/28/20	ISSUED FOR PERMIT & CONSTRUCTION
05/21/20	ISSUED FOR PRICING

Drawn: JDA	Checked: JZ	Approved: JZ
NEW ELEVATOR		
EDGEWOOD JUNIOR/SENIOR HIGH SCHOOL		
MERRITT ISLAND		
FLORIDA		
ELEVATOR SECTIONS		

JOHN C. ZWICK, P.A. FL. REG. ARCH. 0095271	JOHN C. ZWICK, P.A. FL. REG. ARCH. 0095271
44-000568	44-000568
Job No. 62170013	Job No. 62170013
A3.0	A3.0

ARCHITECTS IN ASSOCIATION ROOD & ZWICK, INC.
800 FLORIDA AVENUE SUITE 202 COCOON, FLORIDA 32822 TELEPHONE (823) 657-6038